

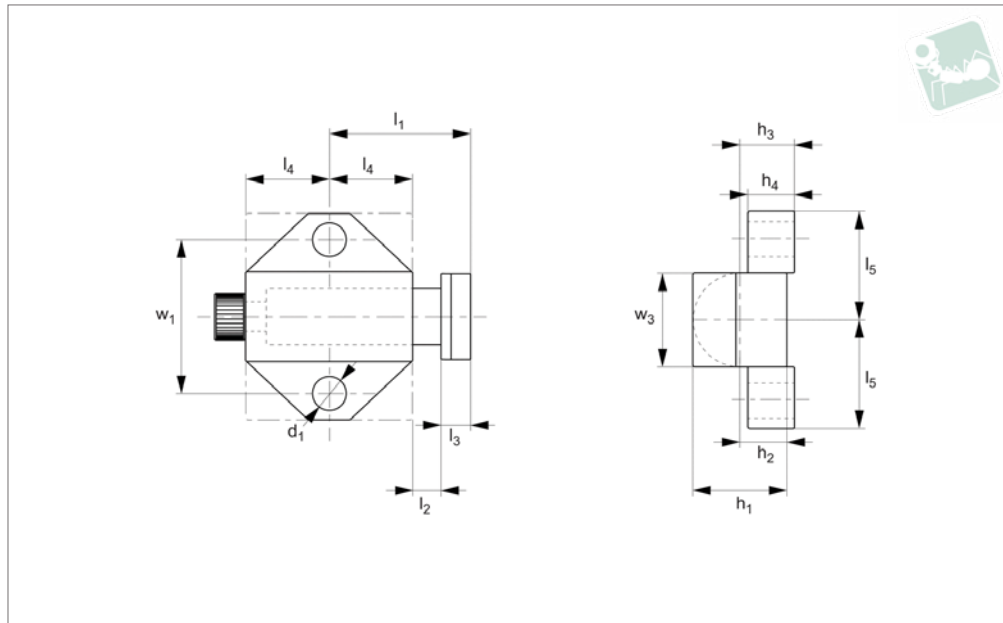

Spring Stop - Inch square nose

Spring Loaded Pins



SL2610

SPRING LOADED PINS

Material

Body: Aluminium.
Nose: Steel 12L14.

clamping.

Tips

Ideal for holding and securing parts while

Order No.	Mounting base	d ₁	l ₁	l ₂	l ₃	l ₄	l ₅	h ₁	h ₂	h ₃	h ₄	w ₁	w ₃	Spring force f ₁ N	Spring force f ₂ N
SL2610.I12-043-A	Triangle	3.25	15.1	3.18	3.18	8.73	11.1	9.53	4.76	5.56	4.76	16.7	9.53	22.25	66.80
SL2610.I18-075-A	Square	4.90	23.8	4.76	6.35	12.7	19.1	15.9	7.94	5.56	6.35	28.6	15.9	8.900	115.7
SL2610.I25-100-A	Square	6.53	31.8	6.35	7.94	14.5	25.4	19.1	9.53	13.4	7.94	38.1	19.1	71.20	213.6