

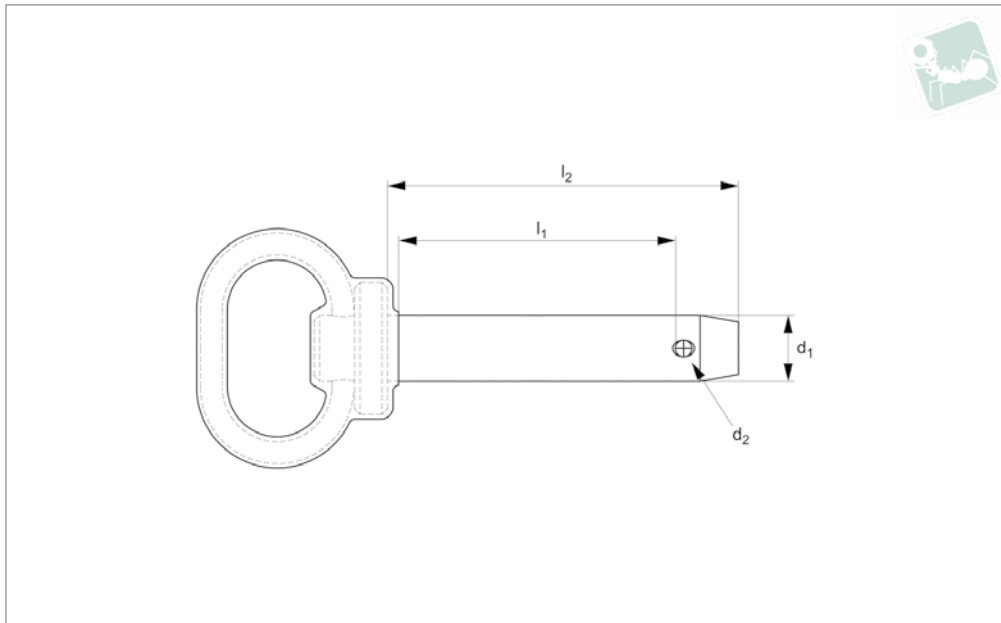

# Hitch Pin - Heavy Duty - Pin Lock steel

## Pull Pins



### PP1726

PULL PINS

#### Material

Pin: Carbon steel, C1008-C1010, zinc plated. With plastic coated handle.

#### Technical Notes

Free rotating toggle at the end of the pin eliminates need for additional fastener (e.g. hitch pin clip, lynch pin, etc.) to secure. To install the pin, rotate toggle

until parallel with the pin and insert in material. After inserting, rotate the toggle 90 degrees to insure the pin will not fall out.

Large handle hitch pin with heavy duty washer to form pin's shoulder. A drilled

hole toward the end of the pin for inserting a keeper fastener; pin clip, lynch pin etc. to sure hitch pin.

#### Tips

Use lanyard or retaining cable to permanently attach wire lock pin to assembly, see part nos. L to LA1224.

Order No.	d <sub>1</sub>	l <sub>1</sub>	d <sub>2</sub>	l <sub>2</sub>
PP1726.050-400-C	12,7 (1/2")	101,6 (4")	4.06	122.94
PP1726.062-450-C	16 (5/8")	114,3 (4 1/2")	4.85	135.64
PP1726.062-600-C	16 (5/8")	152,4 (6")	2.31	122.94
PP1726.075-450-C	19,05 (3/4")	114,3 (4 1/2")	2.31	136.65
PP1726.075-650-C	19,05 (3/4")	165,1 (6 1/2")	2.31	187.45
PP1726.088-450-C	22,35 (7/8")	114,3 (4 1/2")	2.31	149.35
PP1726.088-650-C	22,35 (7/8")	165,1 (6 1/2")	2.31	200.15
PP1726.100-450-C	25,4 (1")	114,3 (4 1/2")	2.31	149.35
PP1726.100-650-C	25,4 (1")	165,1 (6 1/2")	2.31	200.15
PP1726.113-700-C	28,7 (1 1/8")	177,8 (7")	2.31	212.85
PP1726.125-700-C	31,75 (1 1/4")	177,8 (7")	2.31	212.85